This item was submitted to [Loughborough's Research Repository](#) by the author.
Items in Figshare are protected by copyright, with all rights reserved, unless otherwise indicated.

Exploring Madiba's Graphic Heritage Workshop Information Pack

PLEASE CITE THE PUBLISHED VERSION

LICENCE

CC BY-NC 4.0

REPOSITORY RECORD

Harland, Robert G., Yolandi Burger, and Everardt Andre Burger. 2023. "Exploring Madiba's Graphic Heritage Workshop Information Pack". Loughborough University. <https://doi.org/10.17028/rd.lboro.22249465.v2>.

Exploring Madiba's Graphic Heritage
Workshop
Nelson Mandela Foundation
2nd March 2023



NELSON MANDELA
FOUNDATION

Living the legacy



Loughborough
University



Front and inside cover: Statue of Nelson Mandela, City Hall, Cape Town

Exploring Madiba's Graphic Heritage

Workshop

Nelson Mandela Foundation

2nd March 2023

Nelson Mandela (NM) continues to be memorialised in different ways all over the world.

This workshop will share new insights from the *Memorialising Mandela in the Metropolis* project at Loughborough University. It will explore the relationship between toponymy, graphic images, cultural heritage, and place making, in locations named after “Madiba.”

Perspectives from academics, Nelson Mandela Foundation (NMF), creative industries, and delegate participation will be synthesised in the context of research undertaken in South Africa, Brazil, and United Kingdom.

The workshop will end with a session on knowledge exchange and research opportunities for future collaboration.

The *graphic* in graphic heritage

Graphic images are ...

Abstract
Architectural
Designs
Diagrams
Graphs
Non-representational
Pictures
Statues
Structural

Mitchell, W. J. T. (1986). *Iconology: image, text, ideology*, Chicago: The University of Chicago Press. pp.10–13

Architectural imagery



Statues



Designs



“Heritage is a version of the past received through objects and display, representations and engagements, spectacular locations and events, memories and commemorations, and the preparation of places for cultural purposes and consumption.”

Waterton, E., and Watson, S. (2015). *The Palgrave Handbook of Contemporary Heritage Research*, Basingstoke: Palgrave Macmillan. p.1

Abstract

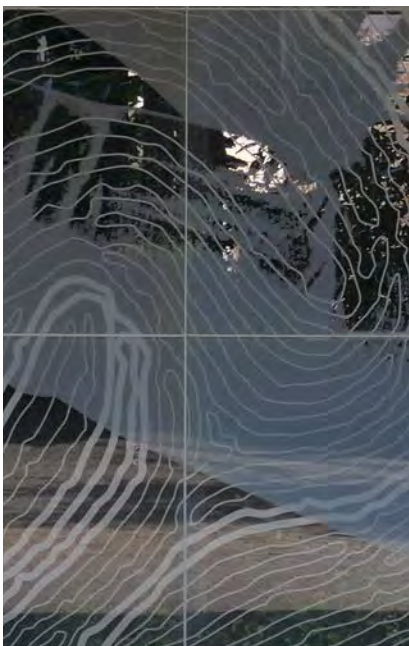

Non-representational



[Infra]structural







Programme

09:15	Arrival	
09:30–10:30	Session 1: Researchers' Perspectives	Razia Saleh (Chair)
	Welcome	
	Introduction to graphic heritage	Dr. Robert Harland
	<i>Memorialising Mandela in the Metropolis</i> project	Dr. Yolandi Burger
	The non-designer's perspective	Dr. Everardt Burger
10:30–10:45	Break (refreshments)	
10:45–12:00	Session 2: NMF and Participants' Perspectives	Dr. Robert Harland (Chair)
	Madiba and Toponymy: A NMF perspective	Prof. Verne Harris Delene Bertasso
	NMF response to the project	Razia Saleh
	The archive as a creative resource	Zandile Myeka
	Activity: Reflection on NM site visits	Dr. Yolandi Burger Dr. Robert Harland Dr. Everardt Burger
12:00–13:00	Lunch (provided)	
13:00–14:00	Session 3: Creative Industries' Perspectives	Dr. Yolandi Burger (Chair)
	Opportunities and challenges of visual auditing of NM sites through photography and videography	Celeste McKenzie Alet Pretorius Fidel Mosupye
	Students' experience of the Photo Market workshop	Tsepiso Mahooe
	Digital Design opportunities	Siboniso Bophela Nkululeko Mthembu
14:00–15:00	Session 4: Sustainable Graphic Heritage Futures	Dr. Robert Harland (Chair)
	Future collaboration, knowledge exchange, research, and funding	
	Break away groups with feedback session and insights	
	Reflection and Implementation in practice	
15:00–End	Vote of thanks (refreshments)	Razia Saleh

Attendees

Ilse Assmann	Apricity Consulting
Delene Bertasso	ENSAfrica
Siboniso Bophela	Open Dialogue
Dr. Everardt Burger	Tshwane University of Technology
Dr. Yolandi Burger	Loughborough University
Dr. Robert Harland	Loughborough University
Prof. Verne Harris	NMF Head of Leadership and Development
Ann-Young Maharaj	NMF Exhibitions Coordinator
Tsepiso Mahooe	Market Photo Workshop
Agreement Maluleke	NMF Archives Intern
Ntombifuthi Mbongo	NMF Accountant
Namile Mchunu	NMF Finance & Procurement Manager
Celeste McKenzie	Documentarian & Ethnographer
Kneo Mokgopa	NMF Narrative Development Manager
Sophia Molelekoa	NMF Digitisation & Audio Visual Archivist
Fidel Mosupye	Supreme Images
Nkululeko Mthembu	PISTA
Zandile Myeka	NMF Archivist: Metadata & Documenting
Emilia Potenza	Apartheid Museum
Alet Pretorius	Photographer
Zanele Riba	NMF Archivist
Razia Saleh	NMF Head of Archives and Research
Helen Tunce	NMF

Floorscape detail, Sandton



“Graphic heritage is set to play an accessible and democratising role for all who are concerned with how heritage interpretation plays out across high-cultural heritage and popular-cultural heritage.”

PRAXIS, University of Leeds (2021)
@Changing_Story_ · Feb 26, 2021, 4:14 PM · Feb 26, 2021



**Newton
Fund**



**UK Research
and Innovation**

Exploring Madiba's Graphic Heritage

Workshop

A United Kingdom Research and Innovation

Newton Fund Consolidation project.

Acknowledgements

Razia Saleh, Head: Archive and Research · Nelson Mandela Foundation
Zandile Myeka, Metadata & Photographs Archivist · Nelson Mandela Foundation
Jean-Luc Koenig, Carla Leigh Ziady, Mike J. Van Heerden · Black Box
Siboniso Bophela · Open Dialogue
Nkululeko Mthembu · PISTA

Published by Graphic Design Research Unit, Loughborough University, 2023
Writing, design, and photography by Robert Harland. ©2023 Robert Harland

Suggested citation

Harland R.G., Burger, Y., and Burger, E.A. (2023) *Exploring Madiba's Graphic Heritage*,
Graphic Design Research Unit: Loughborough University. United Kingdom.
DOI: <https://doi.org/10.17028/rd.lboro.22249465>

A TASTE OF FREEDOM

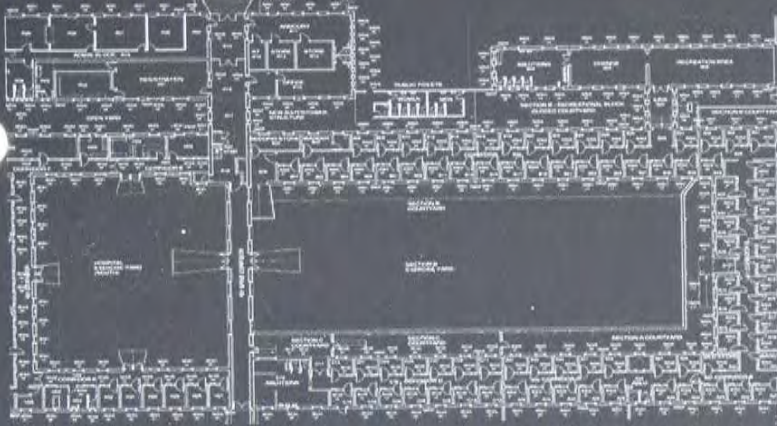

"To plant a seed, watch it grow, to tend it and then harvest it, offered a simple but enduring satisfaction. The sense of being the custodian of this small patch of earth offered a taste of freedom."

NELSON MANDELA

Commemorative sign at Robben Island

Exploring Madiba's Graphic Heritage

Workshop

A United Kingdom Research and Innovation
Newton Fund Consolidation project.



NELSON MANDELA
FOUNDATION

Living the legacy

Detailed graphic image of Nelson Mandela's hand.



Loughborough
University