

- arid | groundwater.
- dying on the surface.
- Australia barren on the centre.
- red centre - dead centre.

15/2/03

Title: "Taking The Pith Out of the Myth".

Concept: English country gardens
failed enterprise - examples in the
out back, wheat belt etc.

Concept: the nature of isolation and its' effect
on creativity, adaptivity, vernacular
adaptation.

The stockman - sunburnt, stressed, alcoholic
exploding the stereotype - removing the romantic
notions of what has and what is "Australia"

- Gardens as a signifier or site to indicate
failed enterprise - the in-built colonial
spirit - taming the immediate environment -
an english country garden in the middle of
the arid landscape - water sealer - waste.

juxtaposition

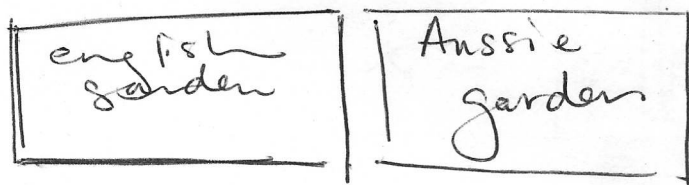

Daniel's garden - attempt at reflecting his own
and mother's experience

- the bush men - the hard tough
colonial spirit.

find myself with mates who are farmers sons,
and miners sons and so on - find myself taking
the piss.

- the "sphere" of reception perception --

from the international community.

peranoia
complicity.

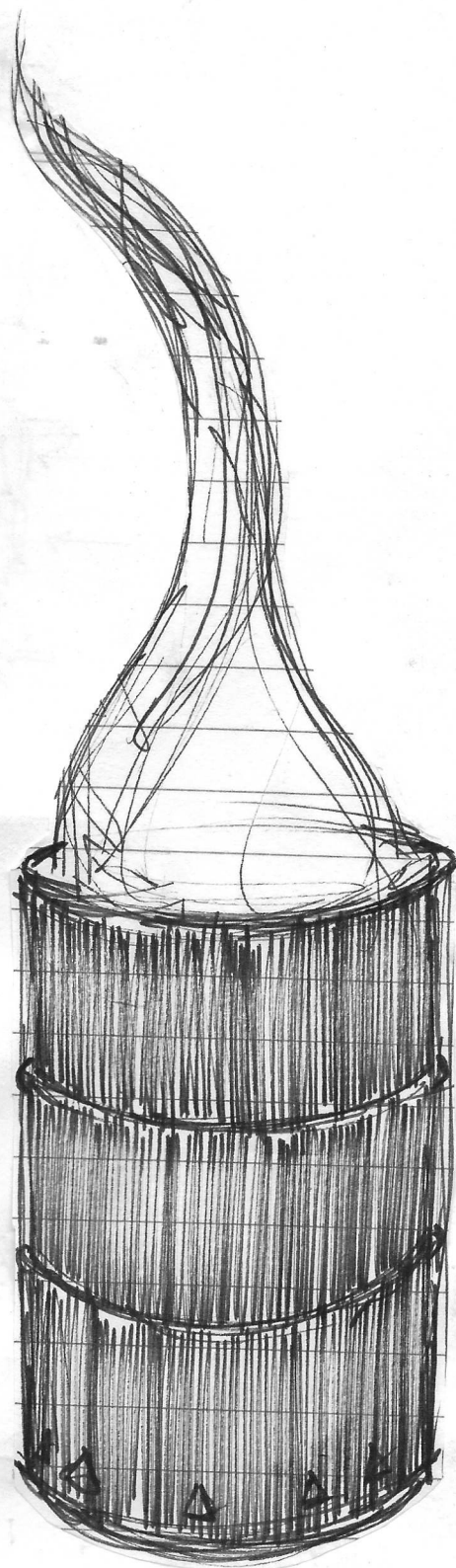
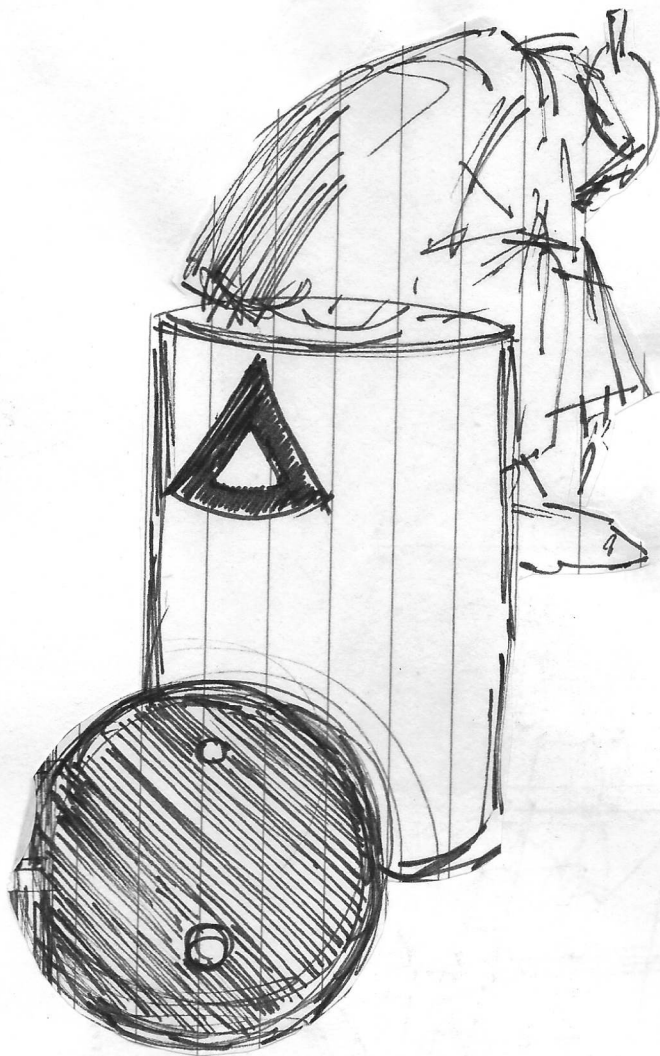

- 12 'cheep' pallets
- 8 cross supports
- 6 uprights.
- 48 drums.
- 4 speakers
- 2 cd players
- 1 amp.
- 4 sound tracks.

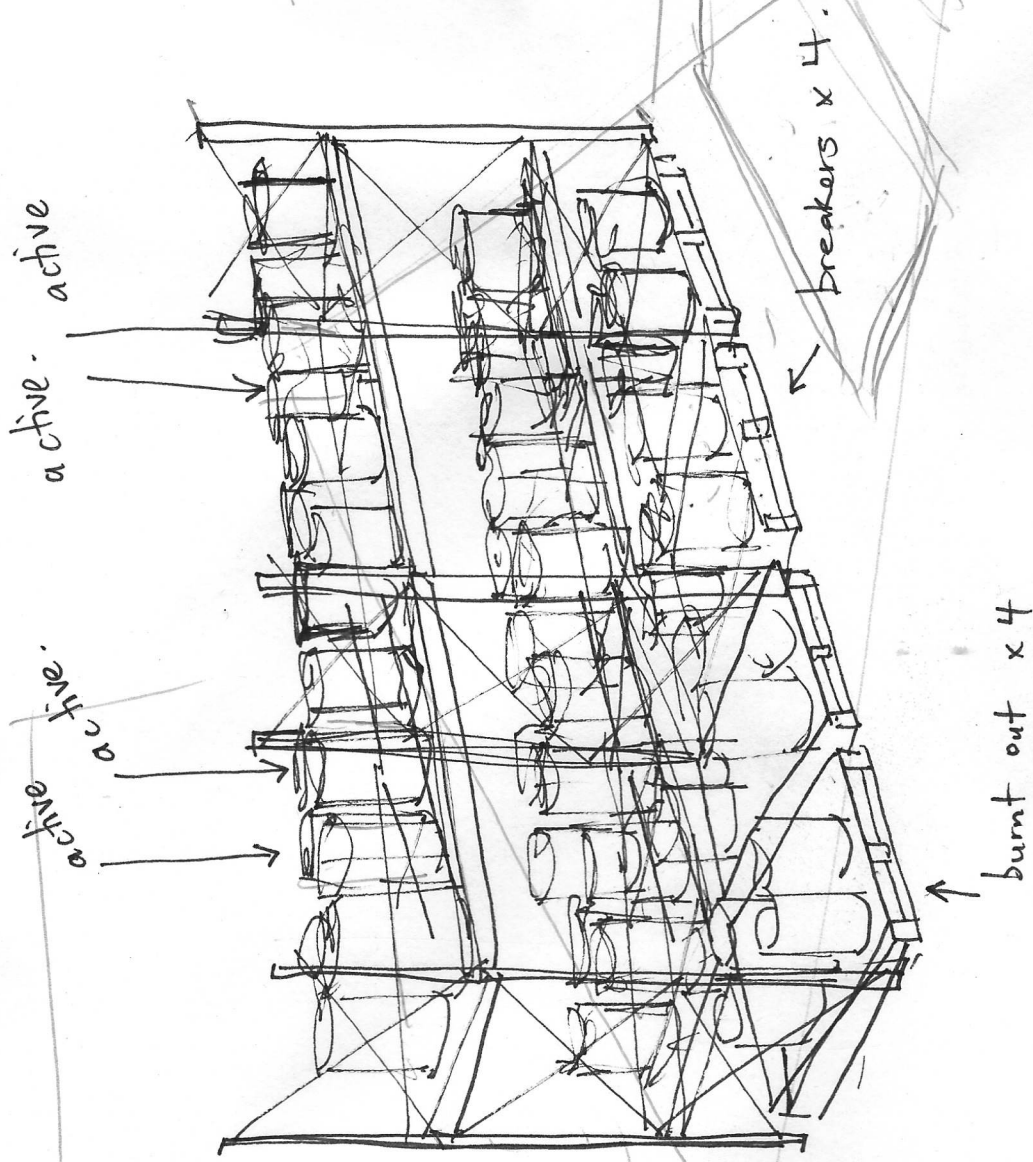

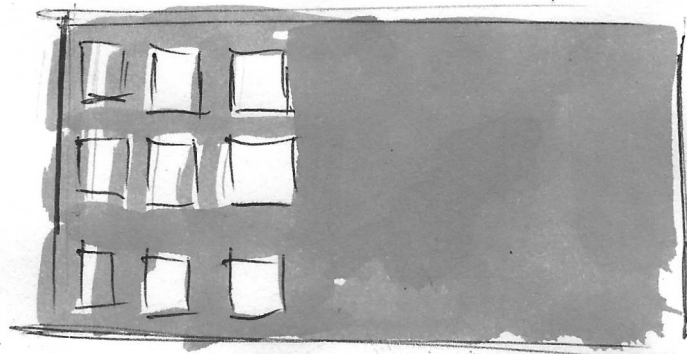

idea for gumbae Sculpture show 2003.

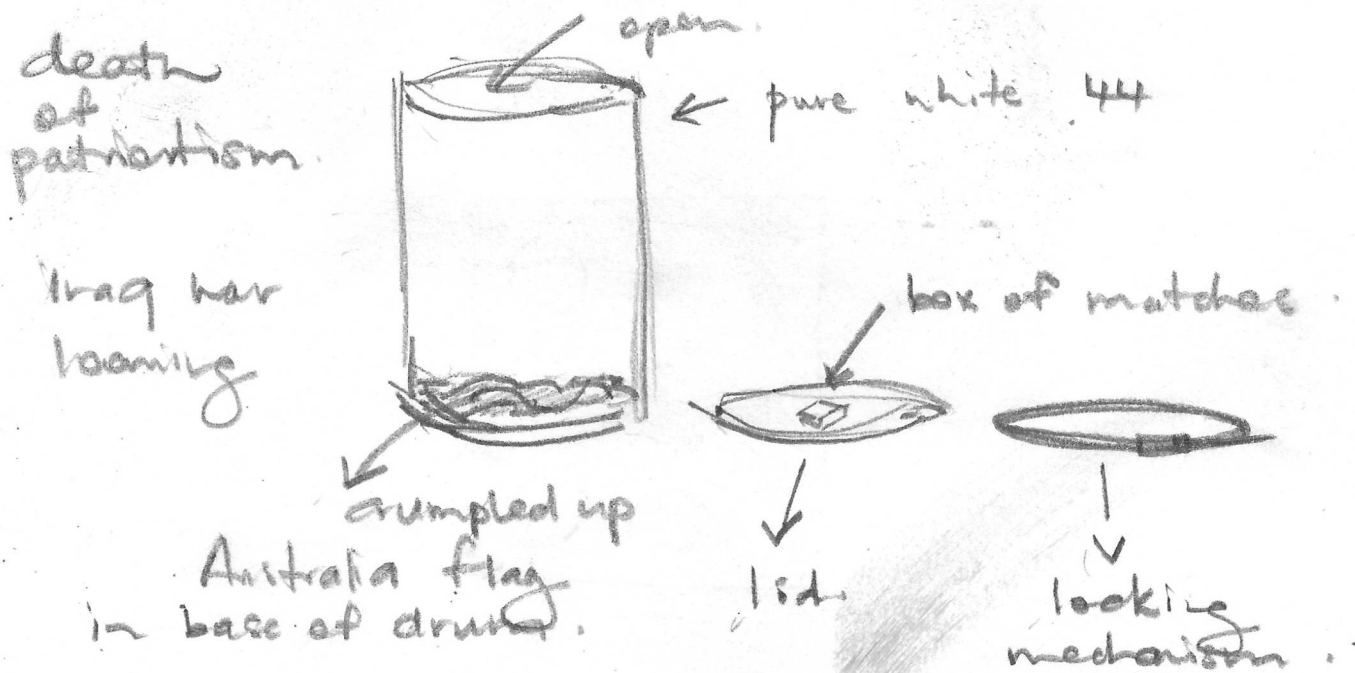

- ridiculous attitudes of youth
- thoughts on laws to ban people burning the flag

3m.
30 in.

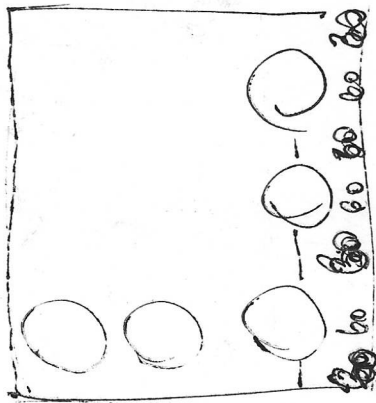

$$\begin{array}{r} 1.2 \\ 1.8 \\ \hline 3.00 \end{array}$$

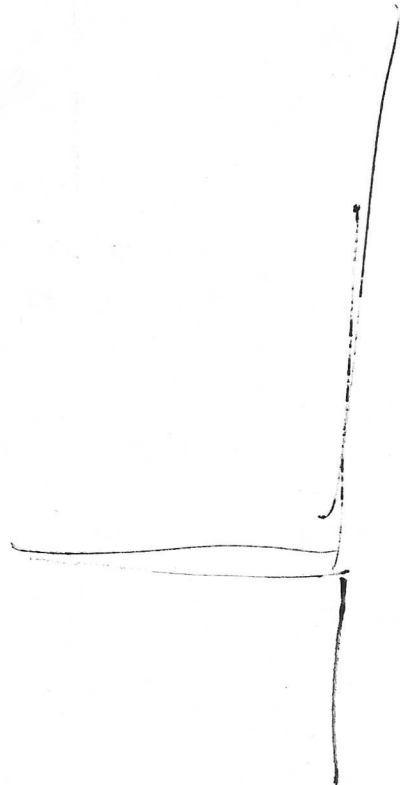

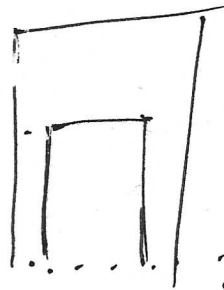
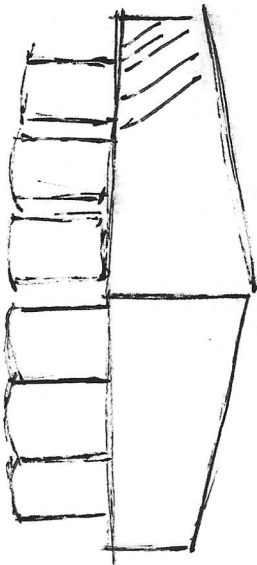
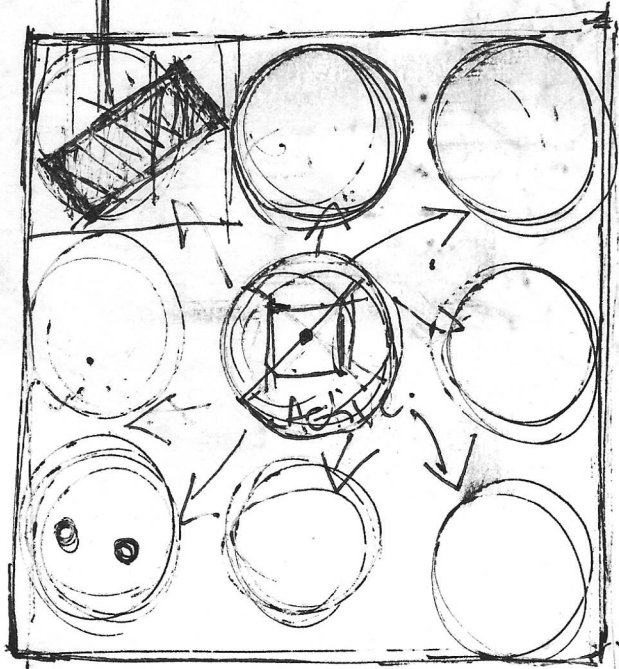
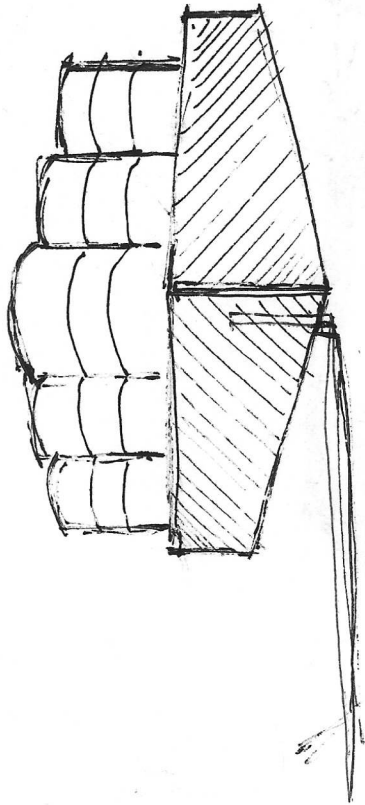
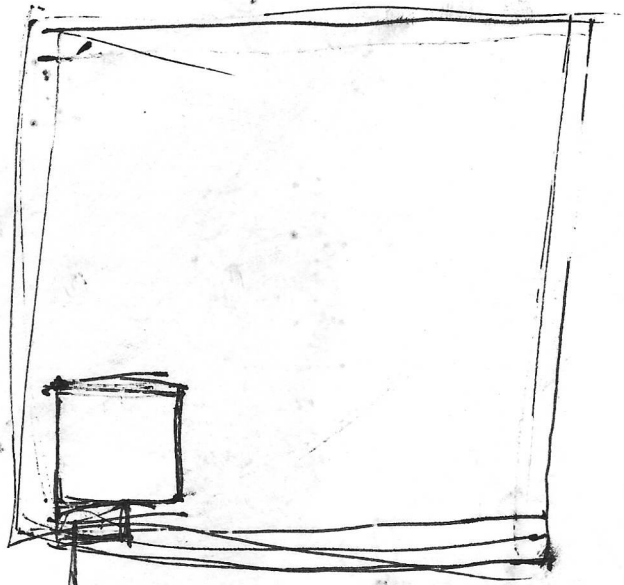
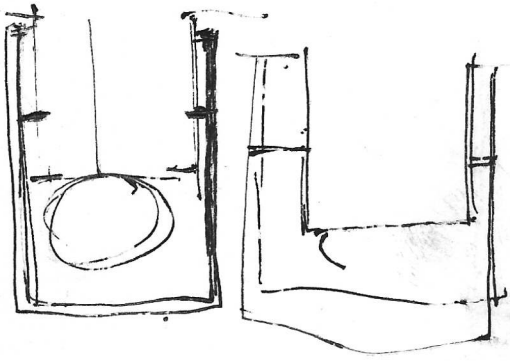

perforations

- AdSL line to patient
- dedicated live sand from location in gallery
- connected to MP3's ^{earphones} down at ad's.